

Johnson Architects, PLLC
 100 NE Northlake Way,
 Suite 200
 Seattle, WA 98110
 T 206.523.9382
 F 206.523.9382

Bellevue Library Parking Expansion

OWNER: KING COUNTY LIBRARY SYSTEM
 SITE: 1111 110TH AVE NE, BELLEVUE, WA 98004

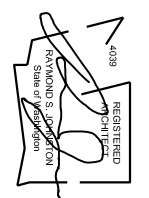
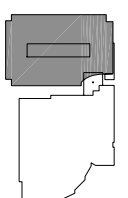

REGISTERED PROFESSIONAL ENGINEER
 RAYMOND S. JOHNSON
 NO. 4038

- DRAWING ISSUE
- DR RESUB 02.14.11
 - 09.11.09 COB DC PERMIT
 - 11.19.09 COB PRE-APP SUB
 - 12.02.09 PRE-APP MEETING
 - 04.22.10 COB DR SUBMIT
 - 08.16.10 COB DR REVISION
 - 09.14.10 BLDG PERM SUBM (NEW GARAGE)
 - 11.24.10 BP CORRECT 1
 - 12.15.10 NEW GARAGE 2
 - 01.20.11 BLDG PERM SUBM (EXIST GARAGE)
 - 02.14.11 COB DR REVISION

CONSTRUCTION
 PHASE BLOCK
 SITE PLAN
 17 FEB 2011

A101

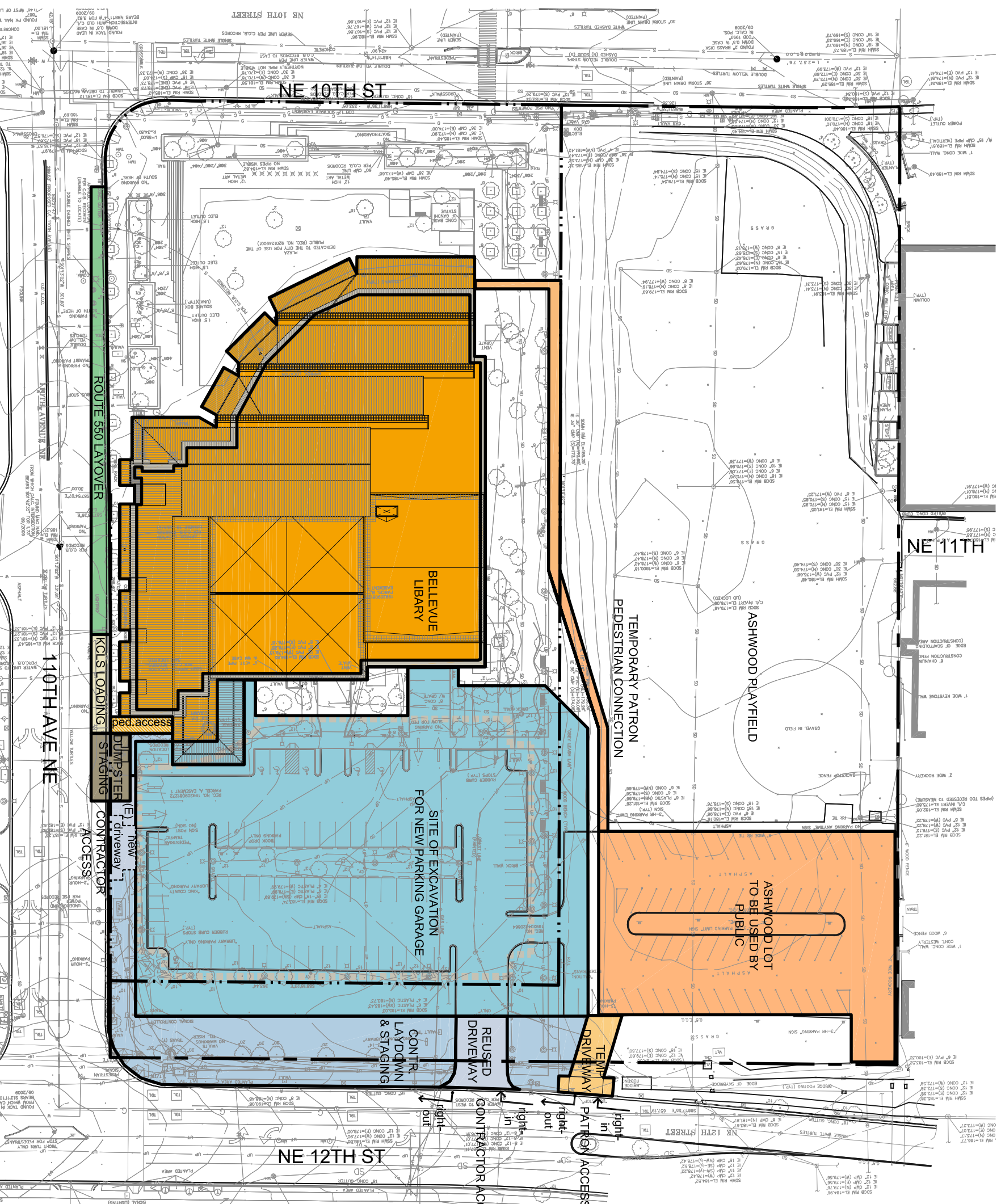

CONSTRUCTION PHASE BLOCK SITE PLAN

